



WHITEMUD17 BUSINESS PARK

Whitemud17 Business Park is strategically positioned within Edmonton's southeast industrial area along Whitemud Drive and 17th Street. The development offers tenants and owner-user groups a unique opportunity to customize a facility by providing multiple options in land size, building configurations, and yard layout. Whitemud17 Business Park can accommodate a variety of uses ranging from oil and gas service operators, distribution, manufacturing, warehousing, equipment storage and more.

LEASING INQUIRIES

CONTACT US TODAY
FOR MORE INFORMATION

Patricia Cayen

SENIOR DIRECTOR, INDUSTRIAL LEASING

403.298.8120

pcayen@hopewell.com

HIGHLIGHTS

- TOTAL AREA:** Approximately 79 acres
- SITE:** Can be subdivided to provide various sizes & configurations
- SERVICES:** Municipal water, sanitary & storm, power, natural gas, telecommunications
- ZONING:** I-M (medium industrial)
I-B (industrial business zone)
DC-2



LOTS FOR SALE

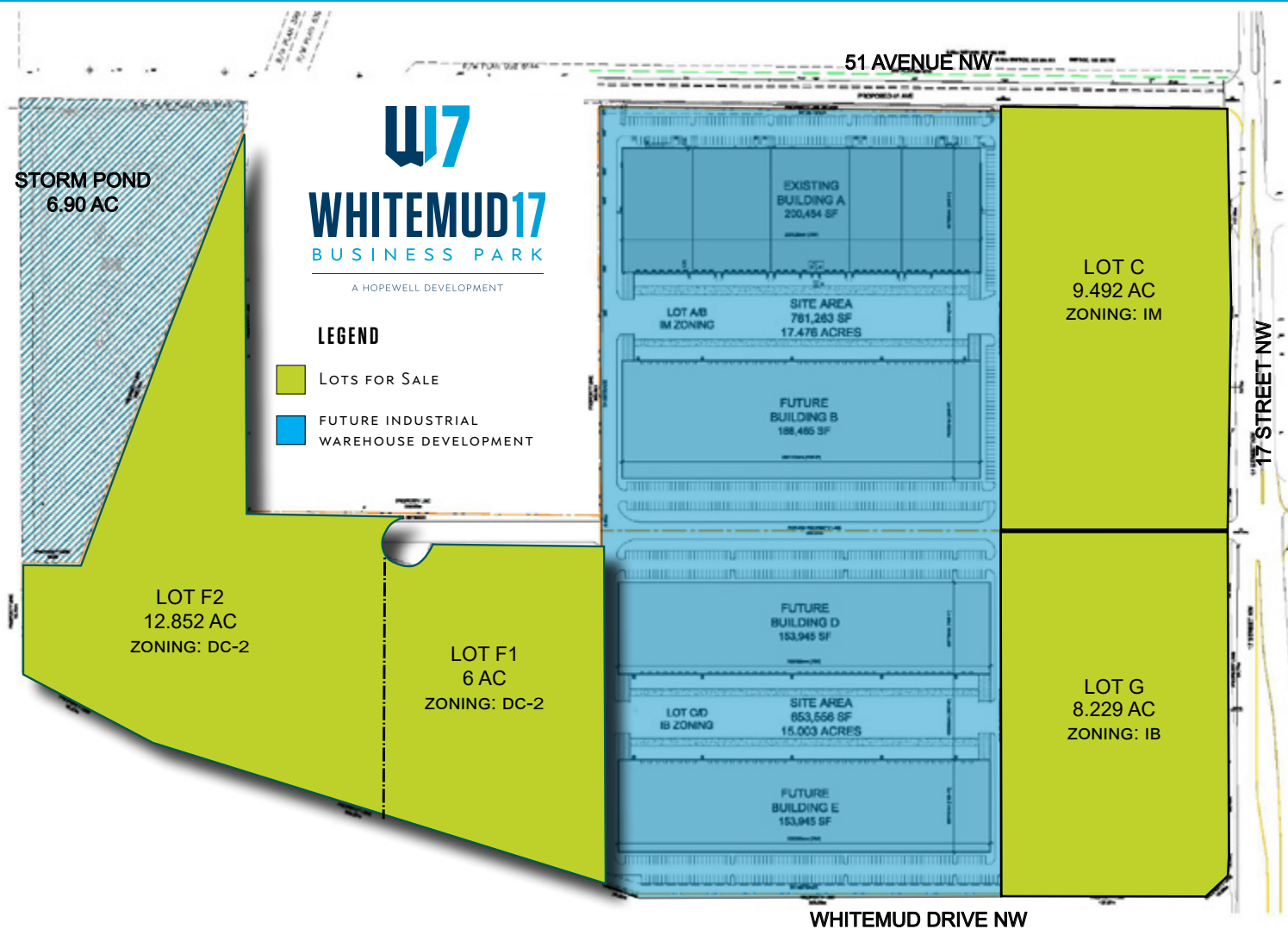

CONCEPTUAL PLANS FOR LOT F

