

Retail | For Lease



Hopewell

CBRE

River Landing East Tower

3,489 SF Ground Floor Retail

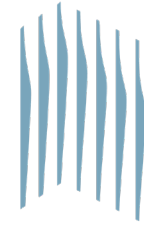

RIVER
LANDING

#100 409 3rd Avenue South
Saskatoon, SK
www.cbre.com

Availability in Saskatoon's Most Prominent New Office Development



River Landing East Tower



The Opportunity

#100 409 3rd Avenue South is located along the South Saskatchewan River at the epicenter of downtown Saskatoon. This location benefits from being on the ground floor of River Landing, home to over 405,000 SF of office space and surrounded by dining, shopping, boutiques, entertainment, outdoor plazas and cultural attractions. Building occupants have access to in-house conference centers and fitness facilities, public plaza and green spaces including walking trails along the South Saskatchewan River.



Opportunity to service the
River Landing Development



Located in Downtown
Epicentre



Outdoor Plaza and
Walkways



Floor Plan



3,489

SF of Retail Space Available

31

Total Storeys of Office

405,000

Total SF of Offices

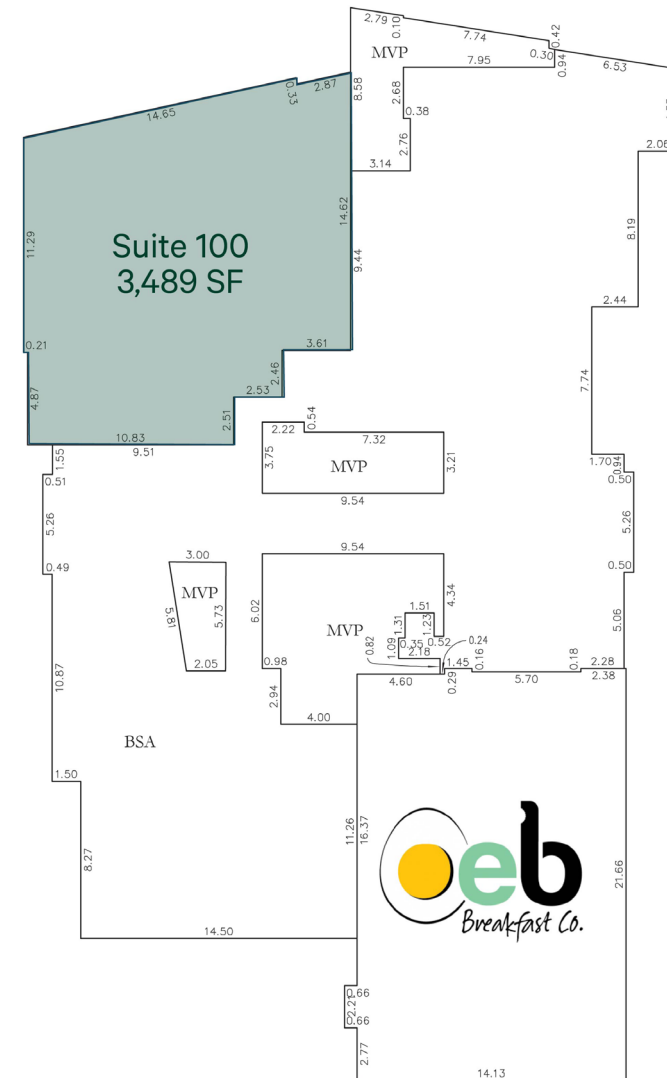

Details

- + Available: 3,489 SF
- + Zoning: DCD1
- + Architectural Control: AC
- + Total SF of Offices: ±405,000 SF
- + Parcel: 203275515
- + Net Asking Rate: \$34.00 PSF
- + Operating Costs: \$16.00 (est.)

Major Tenants: Nutrien, RBC Dominion Security, TD Bank, EY, Scotiabank, Canpotex, MLT Atkins, McKercher LLP, 7Shifts, and IG Wealth Management.

River Landing East Tower

#100 409 3rd Avenue South | Saskatoon, SK

Retail | For Lease



Contact Us

Michael Bratvold

Senior Vice President
+1 306 803 5977
michael.bratvold@cbre.com

Ben Kelley

Associate Vice President
+1 306 803 5979
ben.kelley@cbre.com

Dallon Kuprowski

Senior Financial Analyst
+1 306 803 5983
dallon.kuprowski@cbre.com

Shane Endicott

Senior Associate
+1 306 716 7522
shane.endicott@cbre.com

Luke Jansen

Sales Associate
+1 306 803 5981
luke.jansen@cbre.com

© 2023 CBRE, Inc. All rights reserved. This disclaimer shall apply to CBRE Limited, and to all divisions of the Corporation ("CBRE"). The information set out herein (the "Information") has not been verified by CBRE, and CBRE does not represent, warrant or guarantee the accuracy, correctness and completeness of the Information. CBRE does not accept or assume any responsibility or liability, direct or consequential, for the Information or the recipient's reliance upon the Information. The recipient of the Information should take such steps as the recipient may deem necessary to verify the Information prior to placing any reliance upon the Information. The Information may change and any property described in the Information may be withdrawn from the market at any time without notice or obligation to the recipient from CBRE.

www.cbre.com/riverlanding

